



Nestled in the heart of the “City of a Hundred Spires”, Hilton Prague Old Town creates a sophisticated retreat with its authentic Art Deco interiors, cosy ambience, more than 1,200 square meters of function space, health club & spa, and stylish restaurant and lounge & bar. The welcoming team captures Prague’s charm and generosity with personal service to create a truly seamless experience for Guests.

HILTON PRAGUE OLD TOWN

Located just 25 minutes away from
Vaclav Havel International Airport

prague-oldtown.hilton.com

V Celnici 7 | 110 00

Prague 1 | Czech Republic

T: +420 221 822 100 | F: +420 221 822 200

E: sales.prague@hilton.com

AT A GLANCE

- Fully renovated in 2018
- 303 guest rooms
- 14 meeting rooms
- Business Center
- 1,200 Sq. M of meeting space
- Indoor pool, sauna and fitness center
- Zinc Restaurant, Lounge & Bar
- Underground parking
- Limousine service
- Executive Lounge
- Off-site catering service





OUR ROOMS

GUEST ROOMS

Our completely refurbished 303 guest rooms boast a fresh, yet elegant and stylish design with modern elements and useful leisure and business facilities. A soothing colour palette and carefully thought-out furnishings with Art Deco touches make the space a comfortable place to return to. All guest rooms are non-smoking. Executive room and suite Guests have access to the Executive Lounge.

- Guest rooms: 162 (including 3 rooms with disabled access)
- Deluxe rooms: 59
- Executive rooms: 63
- Junior suites: 6
- Executive suites: 10
- Governor suites: 2
- Penthouse: 1



OUR FACILITIES

GUEST ROOM FACILITIES

- Air conditioning and climate control
- High speed internet, WiFi
- 49-inch flat-screen TV
- Alarm clock and hairdryer
- Mini-bar and laptop-size safe
- Ironing facilities
- Sprinklers
- Complimentary tea and coffee making facilities

LIVINGWELL HEALTH CLUB & SPA

The gym is open 24 hours a day, 7 days a week. The wet areas, including pool and dry sauna, are open daily from 9:00 am to 9:00 pm.

LOCATION

Just 25 minute drive from Vaclav Havel International Airport and located in the heart of the historical city, Hilton Prague Old Town is perfectly positioned for business and leisure Guests, who can explore the fascinating Czech capital and discover its treasures with ease. The famous sites of Prague, such as Wenceslas Square, Charles Bridge and Old Town Square, are all within walking distance, while Namesti Republiky station provides nearby subway access.



MEETINGS AND EVENTS

Hilton Prague Old Town with its 1,200 Sq. M of dedicated meeting space located on a single, separate floor has the flexibility to accommodate up to 800 people. The spacious Dvorak Ballroom hosts up to 340 Guests, while more intimate meetings from two up to 200 attendees can be accommodated in 14 meeting rooms, majority of them with daylight. High speed wireless internet and a wide range of audio-visual technology is personally overseen by a dedicated manager and creative catering for all types and sizes of events is provided by an experienced international team of chefs.

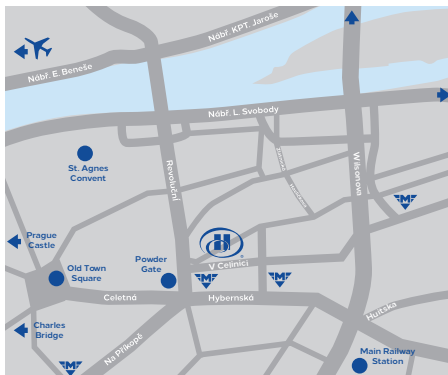

EAT AND DRINK

ZINC RESTAURANT

Be surprised by the delicious fresh tastes and colourful plates from our menu featuring both international as well as authentic local dishes prepared in a modern way. The restaurant interior has been designed by David Collins, reflecting the architecture of Prague, Czech Modernism, Cubism and Art Deco. Our dedicated team looks forward to crafting an authentic experience for our Guests helping them discover something delectable.

Opening hours:

Breakfast - Monday to Friday 6:30 am until 10:30 am, Saturday and Sunday 6:30 am until 11:00 am
Lunch - Noon until 3:00 pm
Dinner - 6:00 pm until 11:00 pm

ZINC LOUNGE & BAR

This stylish bar serves a selection of tempting cocktails, specialty coffees and light snacks.

Opening hours:

9:00 am - 1:00 am

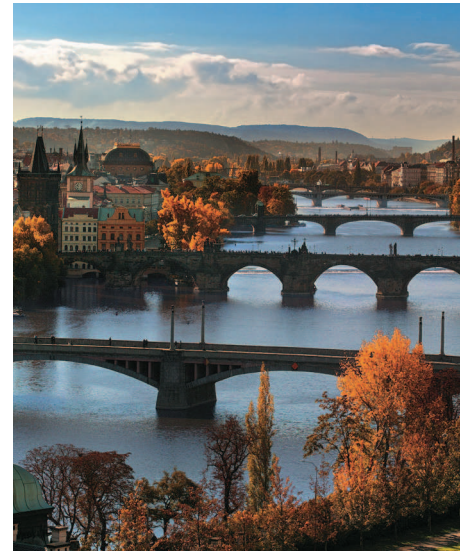

OUT AND ABOUT

- Charles Bridge
- Old Town and Wenceslas Squares
- Prague Castle
- Jewish Quarter
- National Theatre
- National Museum of Prague
- Powder and Petrin Towers
- State Opera
- Municipal House

Floor Map

Floor Map Key

- Meeting/Conference Rooms
- Amenities
- Public Space
- Private
- ♂ ♀ Toilets
- ⬆ ⬇ ⬆ Elevator
- ↕ Stairs

Lobby Floor

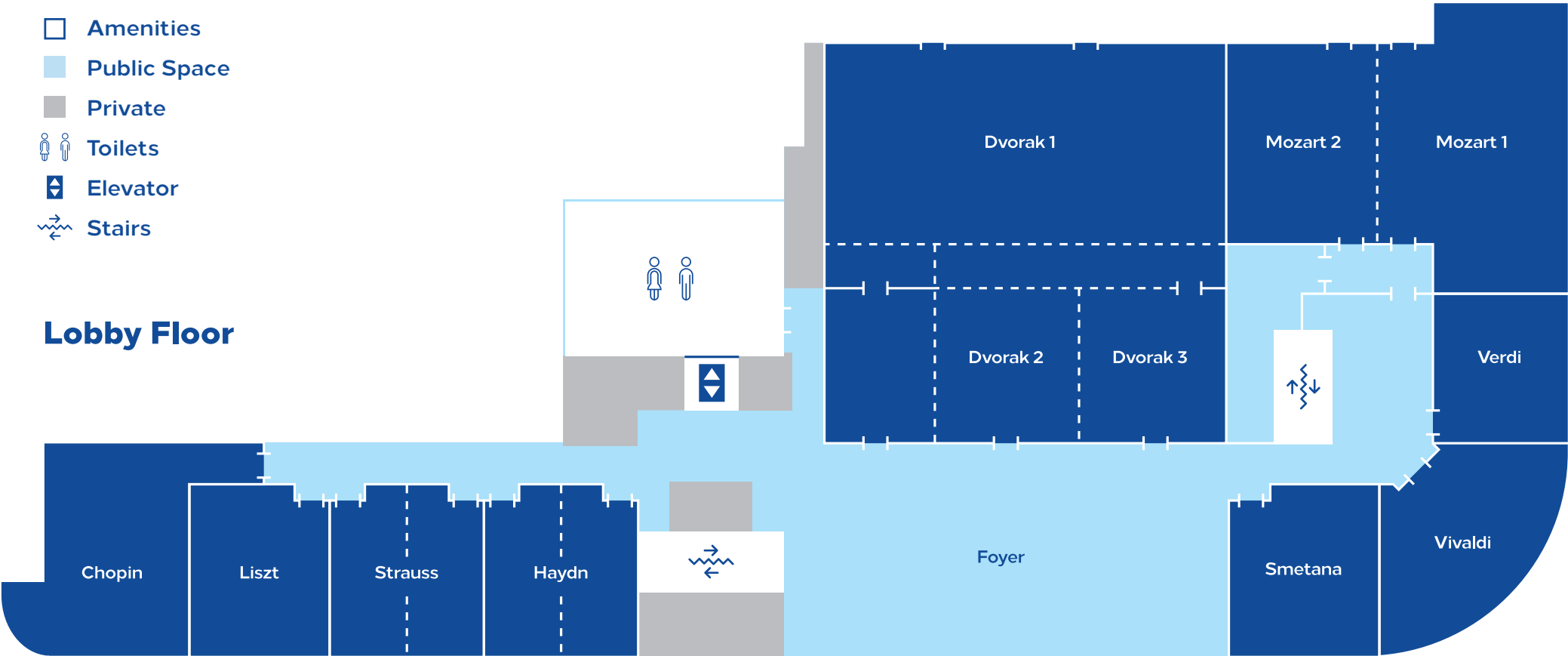

prague-oldtown.hilton.com

V Celnici 7 | 110 00 Prague 1 | Czech Republic | T: +420 221 822 100 | F: +420 221 822 200 | E: sales.prague@hilton.com

Conference And Event Rooms Capacity Chart



Name	Type	Location	Area (Sq. Ft)	Area (Sq. M)	Size L x W x H (M)	Classroom	Theatre	Banquet	Cocktail Reception	U-Shape	Cabaret	Boardroom	Natural Daylight
Grand Ballroom Dvorak	Ballroom	2 nd Floor	4004	372	18.9 x 19.5 x 2.7	200	340	240	340	-	144	-	-
Dvorak 1	Multi	2 nd Floor	2476	230	18.9 x 12 x 2.7	140	240	170	240	68	102	70	-
Dvorak 2	Multi	2 nd Floor	560	52	7.2 x 7.5 x 2.7	27	50	40	50	20	18	24	-
Dvorak 3	Multi	2 nd Floor	560	52	7.1 x 7.5 x 2.7	27	50	40	50	20	18	24	-
Mozart 1 + 2	Multi	2 nd Floor	2045	190	16 x 14 x 2.7	84	120	100	130	-	48	-	.
Mozart 1	Multi	2 nd Floor	1356	126	9 x 14 x 2.7	60	80	70	80	40	46	38	.
Mozart 2	Multi	2 nd Floor	700	65	9 x 7.2 x 2.7	24	40	40	52	15	24	22	-
Verdi	Multi	2 nd Floor	452	42	7.1 x 6.3 x 2.7	24	40	30	35	16	18	16	.
Vivaldi	Multi	2 nd Floor	646	60	10 x 7.1 x 2.7	24	45	40	52	12	18	22	.
Smetana	Multi	2 nd Floor	538	50	6.9 x 7.2 x 2.7	24	50	30	50	20	18	22	.
Haydn 1 + 2	Multi	2 nd Floor	560	52	6.9 x 7.5 x 2.7	27	50	40	50	20	24	22	.
Haydn 1	Multi	2 nd Floor	269	25	3.4 x 7.5 x 2.7	12	24	-	20	-	-	12	.
Haydn 2	Multi	2 nd Floor	269	25	3.4 x 7.5 x 2.7	12	24	-	20	-	-	12	.
Strauss 1 + 2	Multi	2 nd Floor	560	52	6.9 x 7.5 x 2.7	27	50	40	50	20	24	22	.
Strauss 1	Multi	2 nd Floor	269	25	3.4 x 7.5 x 2.7	12	24	-	20	-	-	12	.
Strauss 2	Multi	2 nd Floor	269	25	3.4 x 7.5 x 2.7	12	24	-	20	-	-	12	.
Liszt	Multi	2 nd Floor	581	54	6.9 x 7.9 x 2.7	27	50	32	50	20	24	22	.
Chopin	Multi	2 nd Floor	775	72	10.25 x 7.1 x 2.6	40	60	50	60	28	30	30	.